

perma PRO LINE

Quick Start Guide



Scan the QR code for a video tutorial.

Assembly

1 | INSERT BATTERY

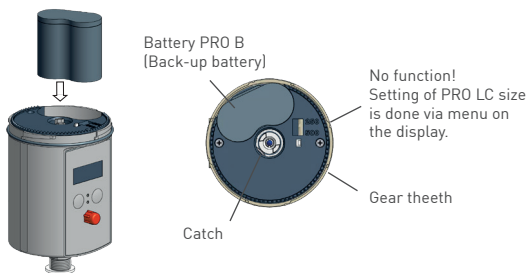

Insert the battery PRO B into the drive unit (according to the direction of the arrow on the label).

2 | COVER FOR PRO LC & PLUG

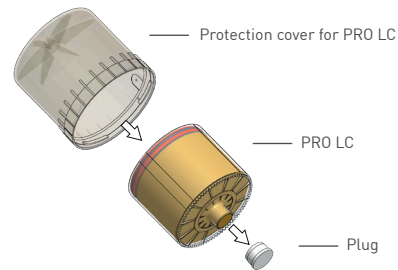

Place the PRO LC inside the protection cover and remove the plug of the PRO LC.

3 | DISCHARGE OPENING

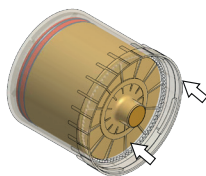

Push the PRO LC into the protection cover until lubricant comes out of the opening

4 | DRIVE



Place the PRO LC with its protection cover on the drive unit. Turn the cover clockwise until the bayonet catch locks.

Display



Lubrication system turned off (OFF)



Lubrication system turned on (ON)

Display shows „remaining discharge period“

Control Buttons

Press	Short	Short	Long > 4 sec. until the display content changes completely	Long > 4 sec. until the display content changes completely
Button				
Function	Selection in current display	Changing of values	Moves to new menu and saves selected values	Returns to original menu without saving changes

Settings and Display

	Display		Meaning / Description	
			Display at delivery with attached PRO LC	
			Display: Discharge time remaining PIN-reset	Info
		Change first digit 	Enter first digit of current PIN PIN "00" at delivery	PIN-Entry
		Change second digit 	Enter second digit of current PIN	PIN-Entry
		Change from LC500 to LC250 	Set PRO LC size	LC
		Outlet 1 On / Off 	Activate outlets: Activate outlet 1 Outlets only displayed if MP-6 is connected	Outlets
			Outlet 1 activated	
		Outlet 2 On / Off 	Outlet 2 activated (if desired, other outlets may be turned On / Off the same way)	Outlets
		Changing the number of strokes 	Enter number of strokes for outlet 1	Strokes
		Change first digit 	Pause time configuration for outlet 1: Changing the first digit	Pause time
		Change second digit 	Pause time configuration for outlet 1: Changing the second digit	
		Change first digit 	PIN (first digit) enter for initial configuration or after a PIN-reset - otherwise, setting is complete	PIN
		Change second digit 	PIN (second digit) enter for initial configuration or after a PIN-reset	
			Configuration finished	

Repeat for each outlet:
Configuration of strokes and
pause time

Total discharge period

- short push
- long push
- blinking display
- go to

I N T R O
C O N F I G U R A T I O N M E N U